

PLATFORM ASSEMBLY

Tools Required:

Power Drill/Driver

1/8" Drill Bit

#2 Phillips Bit

T-30 Torx Bit

PLATFORM ASSEMBLY INSTRUCTIONS

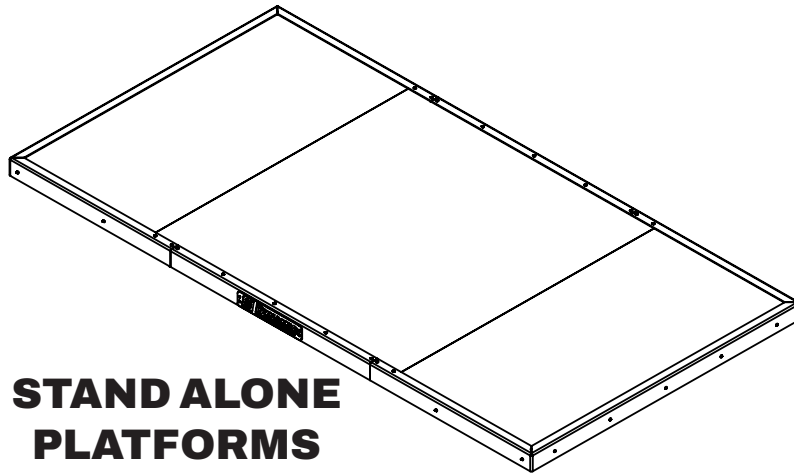

**STAND ALONE
PLATFORMS**

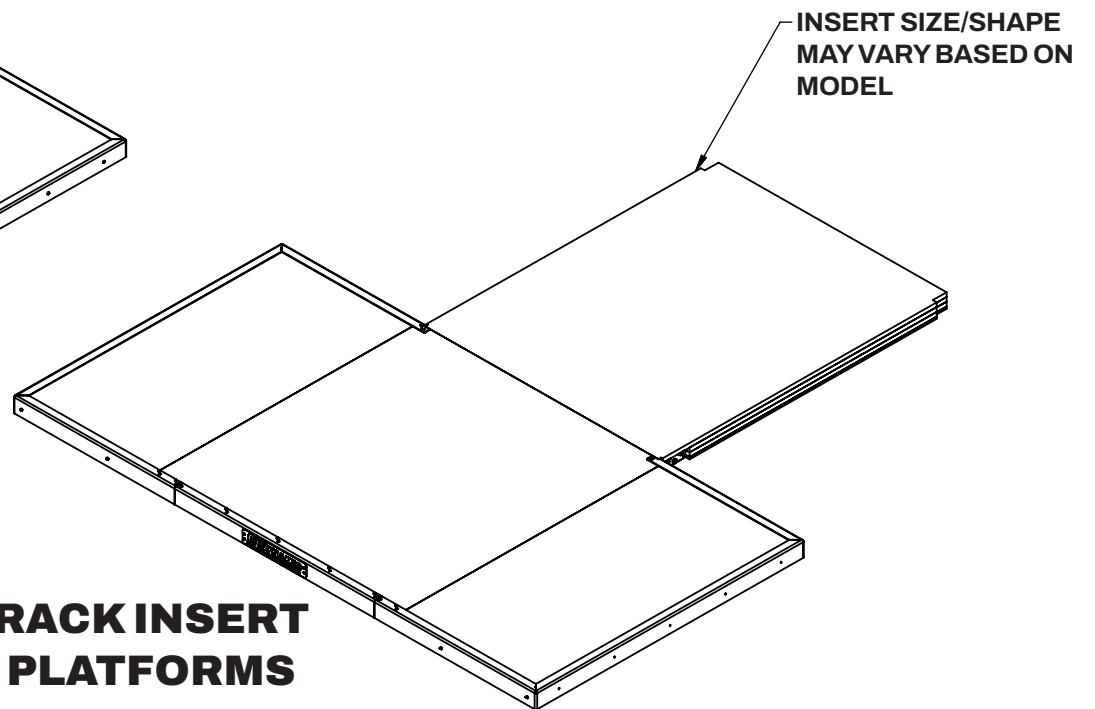

**RACK INSERT
PLATFORMS**

INSERT SIZE/SHAPE
MAY VARY BASED ON
MODEL

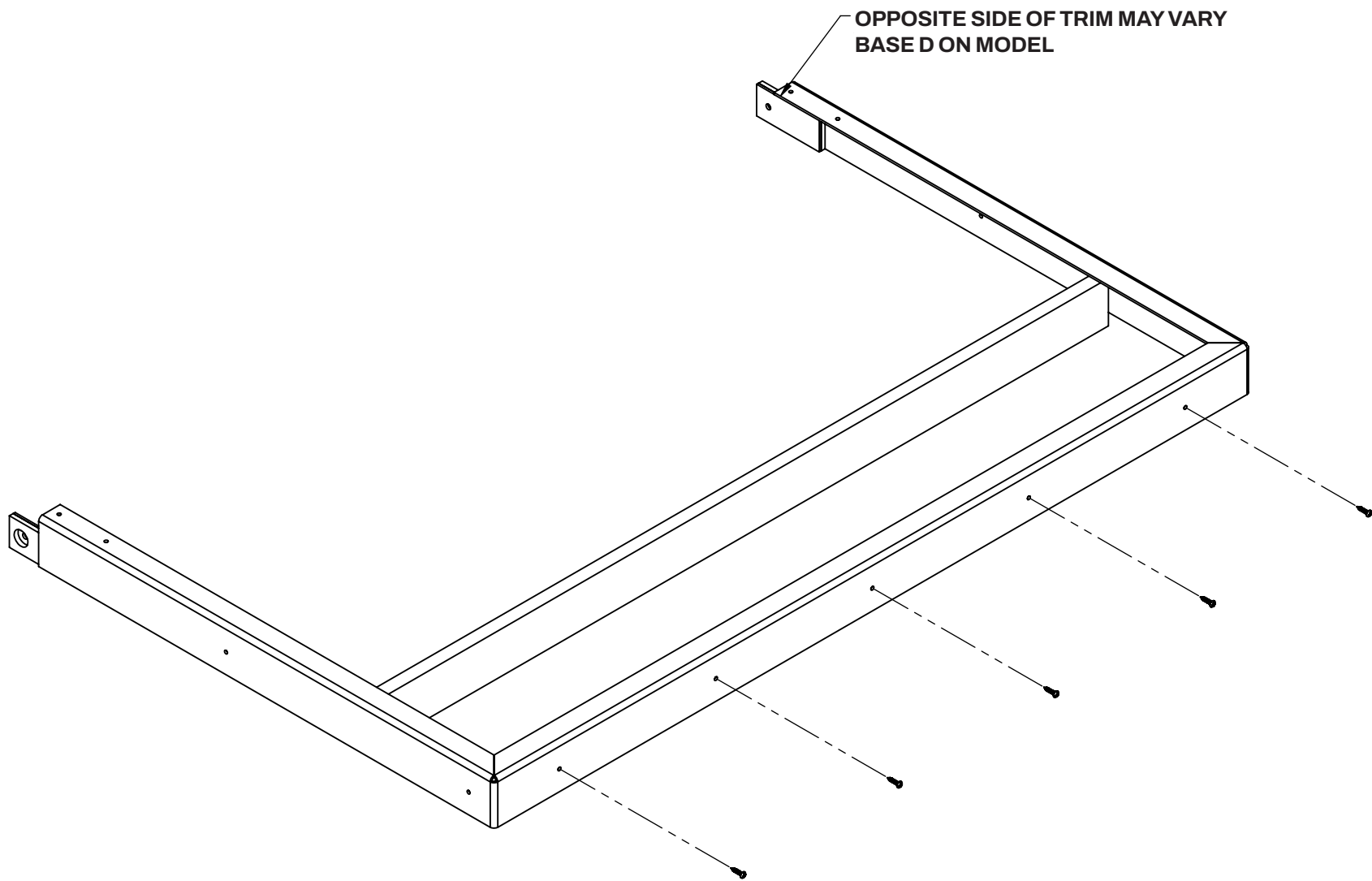

Step 1

Verify wood is installed on the inside of the platform. If wood is not present, install 1" x 3" wood strip on the inside of each side trim piece as shown. Tighten supplied #8 x 3/4" screws using Phillips head screw driver. Repeat for opposite side.

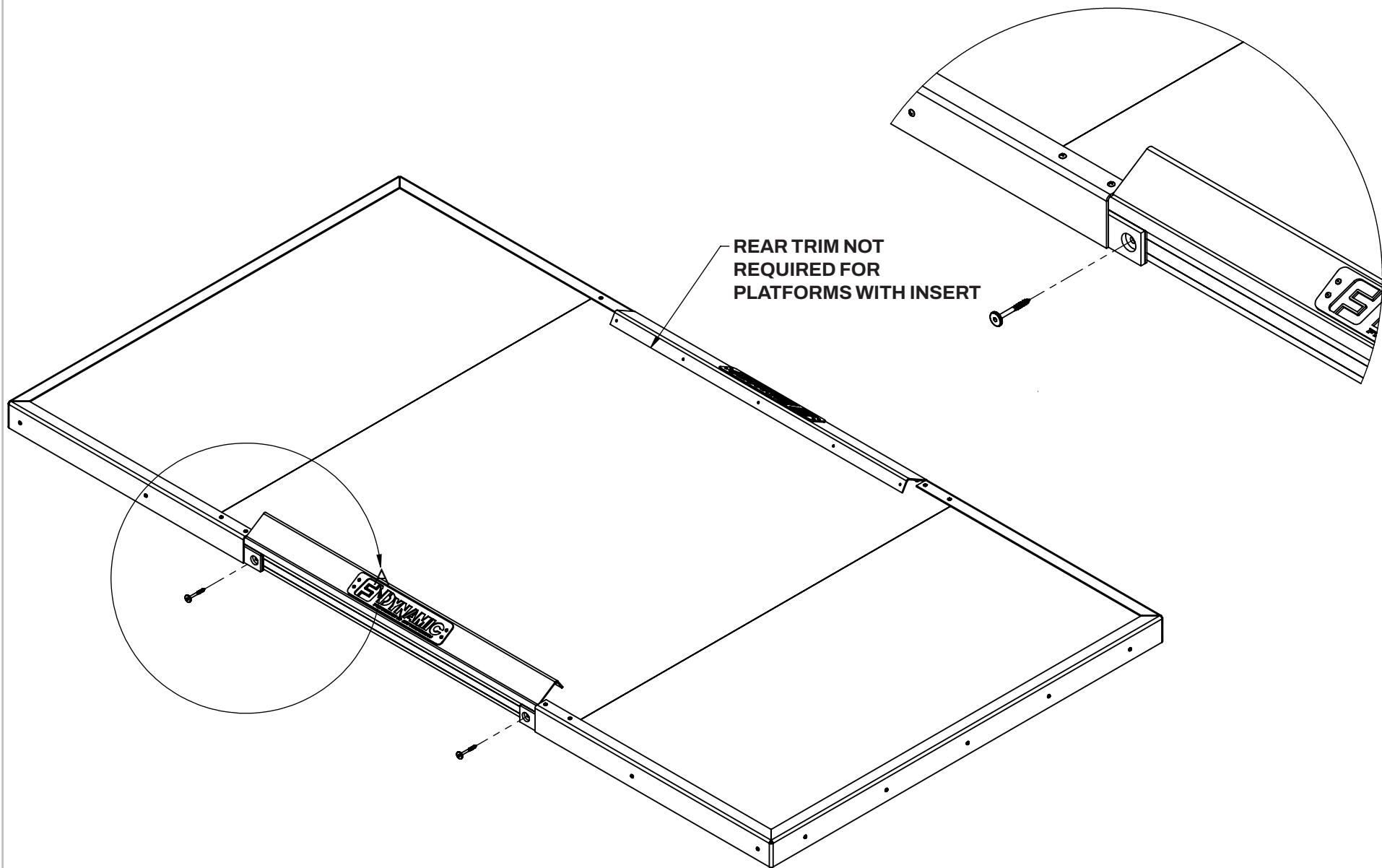

NOTE

If installing platforms insert, see step 4 before installing trim.

Step 2

Align all center pieces of wood, rubber and trim together. Using center trim plates as a spacer, center the trim on the wood platform. Line up and pre-drill the holes for the lag bolts. Once pre-drilled install the lag bolts as shown.

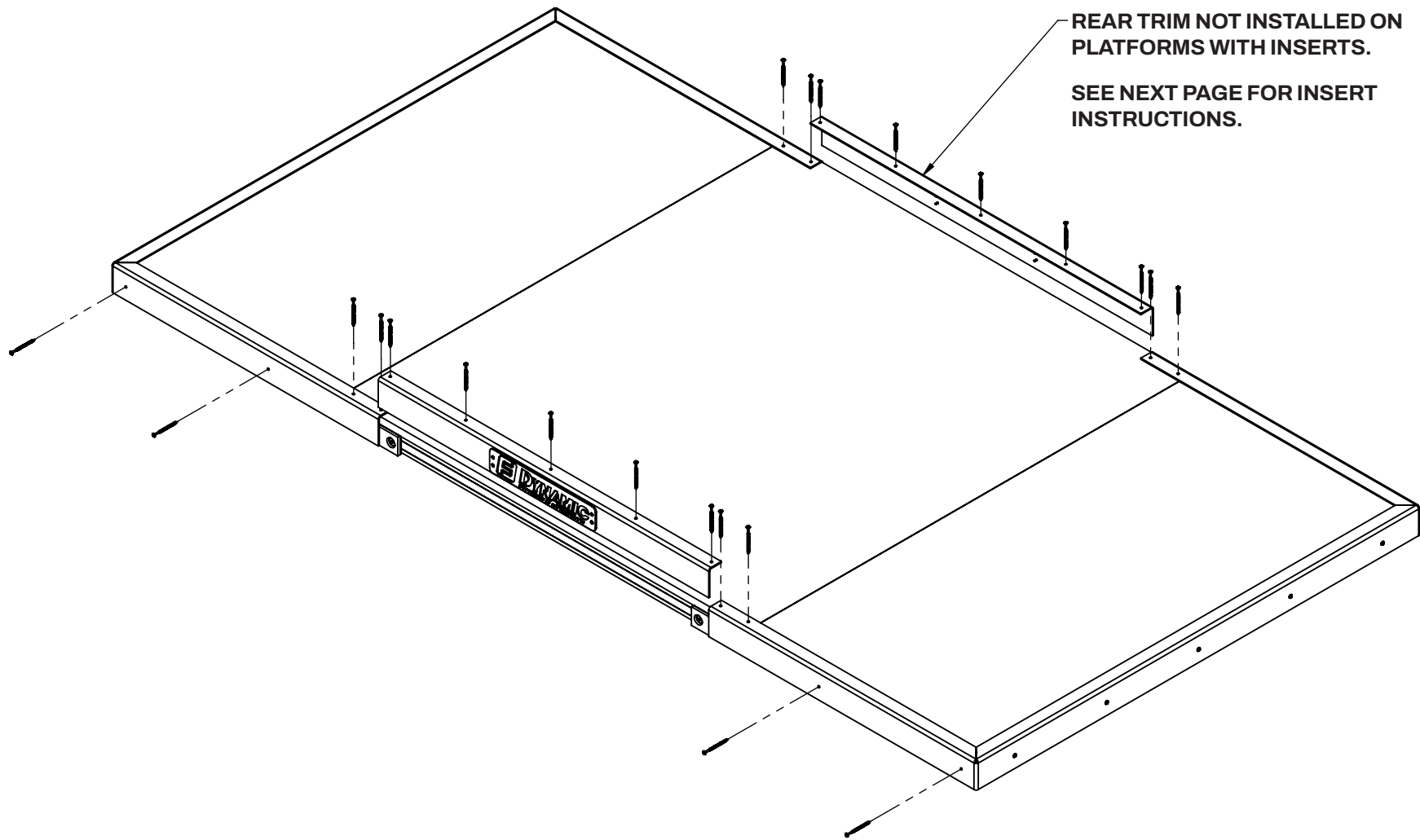

Step 3

Line up center trim piece onto platform, and then pre-drill all remaining trim holes. Once pre-drilled, install the remaining screws as shown.

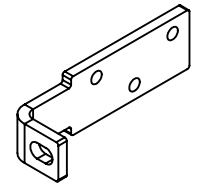
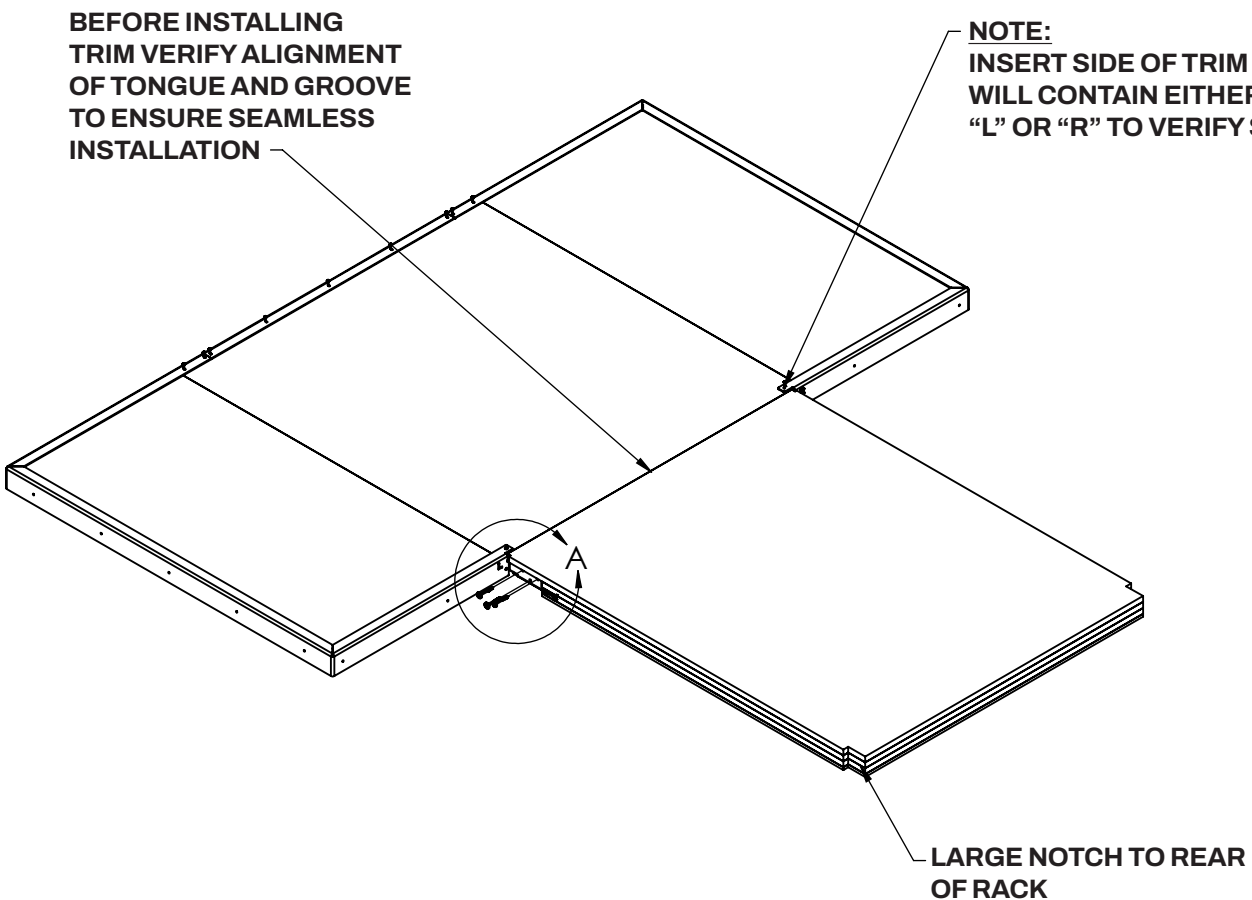

(2X) L BRACKETS
REQUIRED FOR INSERT
INSTALL

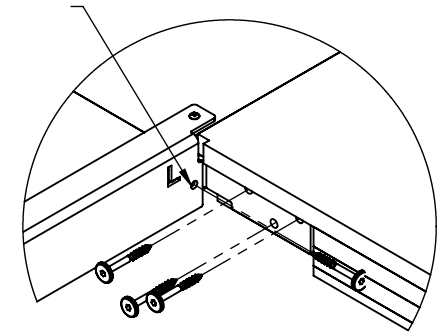

DETAIL A

Step 4 (Platforms with Inserts ONLY)

Install platform insert onto rear of platform using (2X) L Brackets as shown in detail A. Secure using (3X) Lag Bolts into rear insert, and (1X) Lag Bolt through trim and bracket, into platform.

Pre-drilling holes with 1/8" drill bit is recommended.

Verify all hardware is tight before use.